



# 5R LITE

MOTORCYCLE BLUETOOTH<sup>®</sup> COMMUNICATION SYSTEM

## QUICK START GUIDE

1.0.0

ENGLISH

### Downloadable Sena Software

Download the **SENA MOTORCYCLES App** on **Google Play Store** or **App Store**.

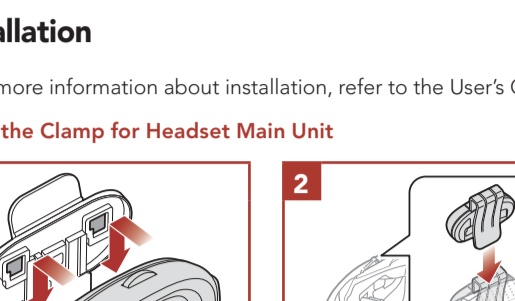

Download the following items at [sena.com](http://sena.com).

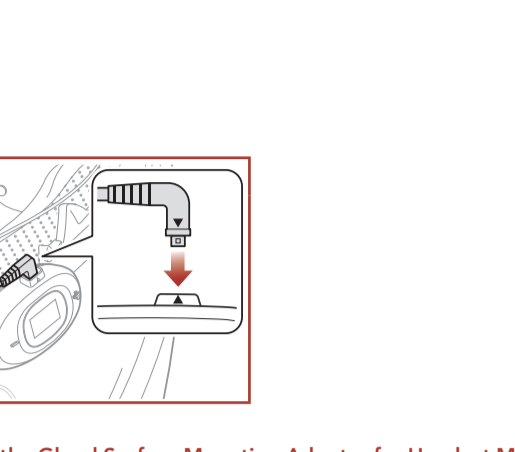

Follow us on Facebook, YouTube, Twitter and Instagram to check the latest information and helpful tips.

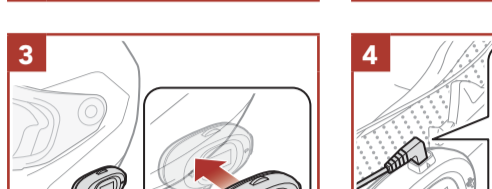

### Product Details

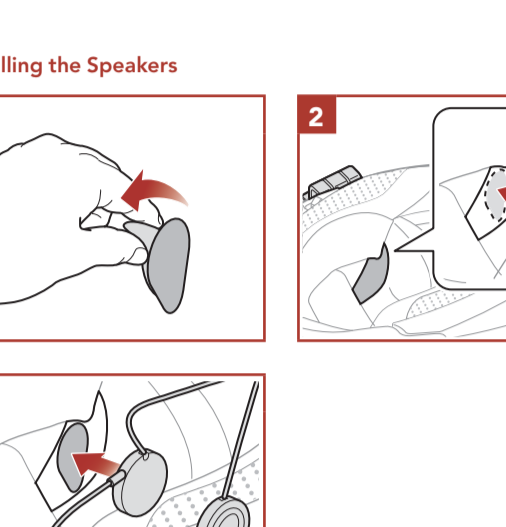

### Installation

For more information about installation, refer to the User's Guide.

#### Using the Clamp for Headset Main Unit

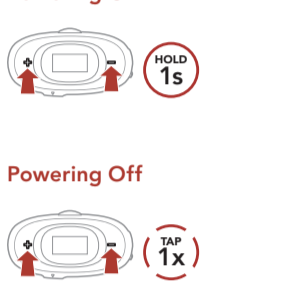

#### Using the Glued Surface Mounting Adapter for Headset Main Unit

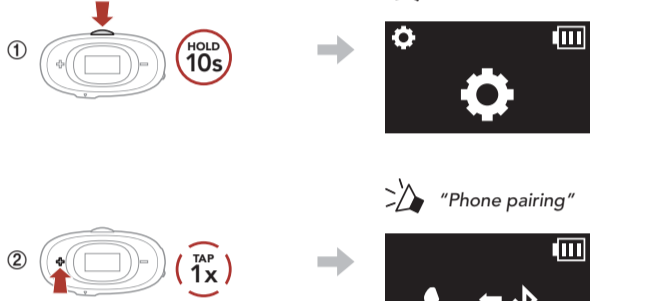
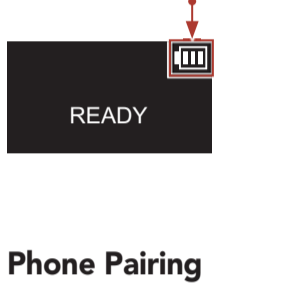
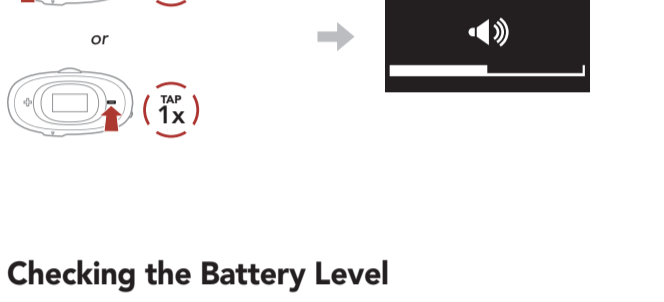

#### Installing the Speakers

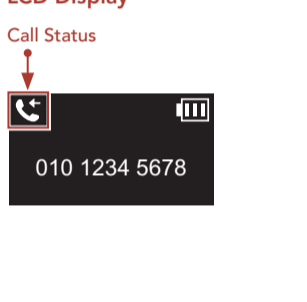
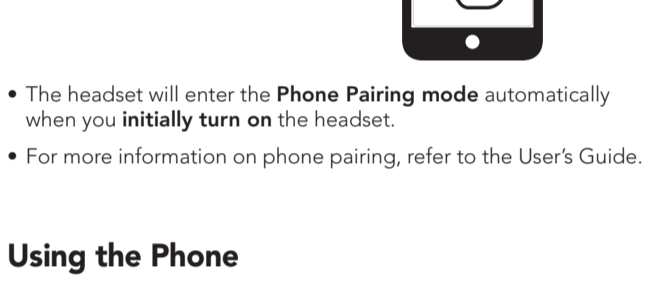
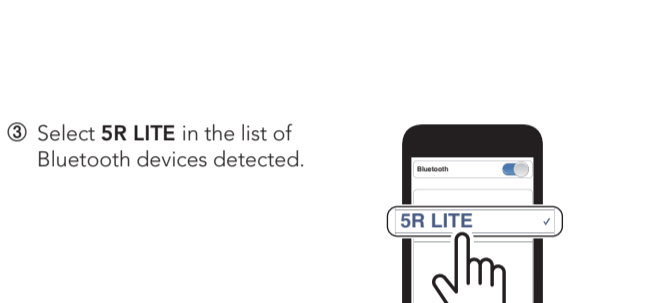

### Icon Legend

- TAP 1x**: Tap button the specified number of times
- HOLD 10s**: Press and Hold button for the specified amount of time
- "Hello" Audible prompt

### Basic Operations

#### Powering On



#### Powering Off

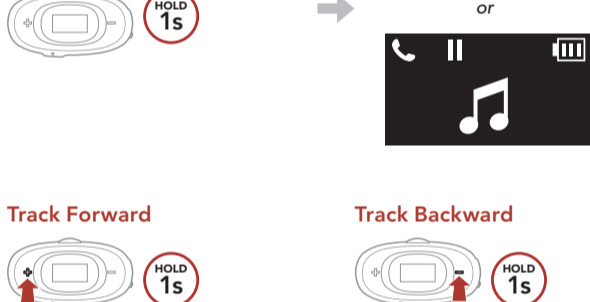

#### Volume Up/Down



### Checking the Battery Level

#### LCD Display



### Phone Pairing

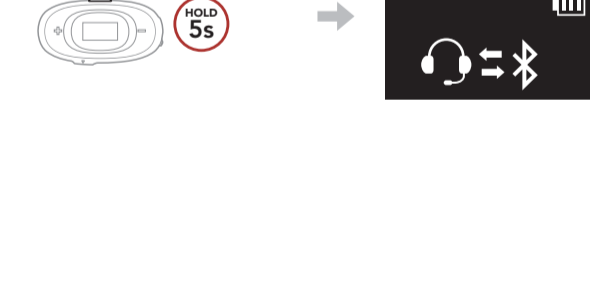
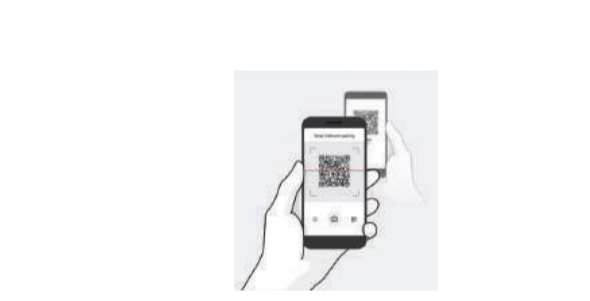

The headset will enter the **Phone Pairing mode** automatically when you **initially turn on** the headset.

For more information on phone pairing, refer to the User's Guide.

### Using the Phone

#### LCD Display

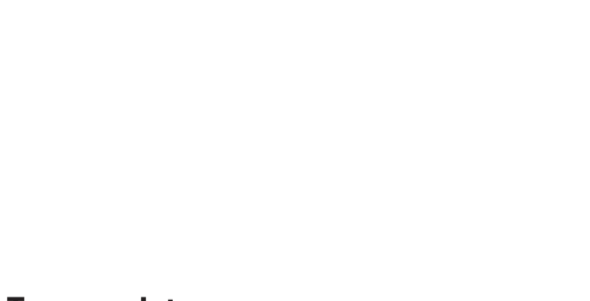

#### Answer a Call



#### End a Call



#### Reject a Call



#### Voice Dialer

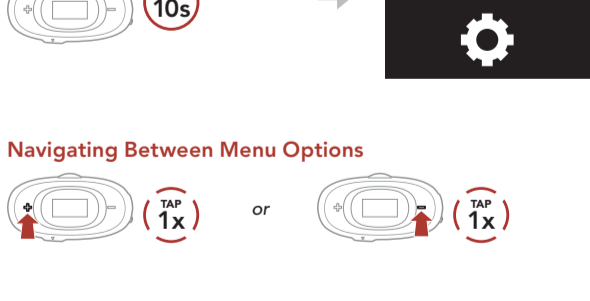

### Music Control

#### Play/Pause

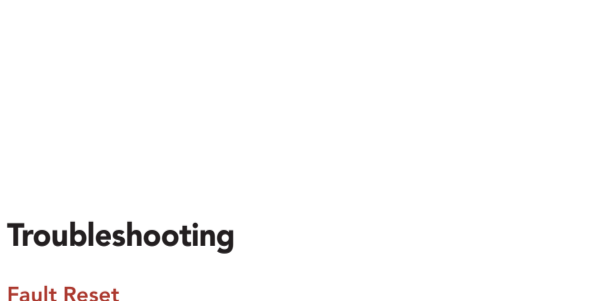

#### Track Forward

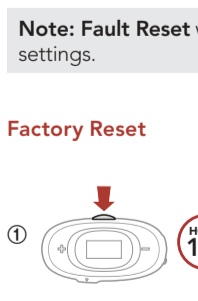

#### Track Backward

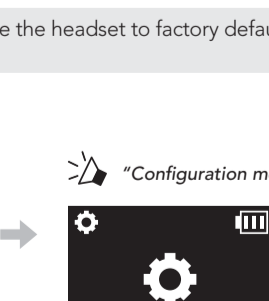

### Bluetooth Intercom

Up to three other people can be paired with the headset for Bluetooth intercom conversations.

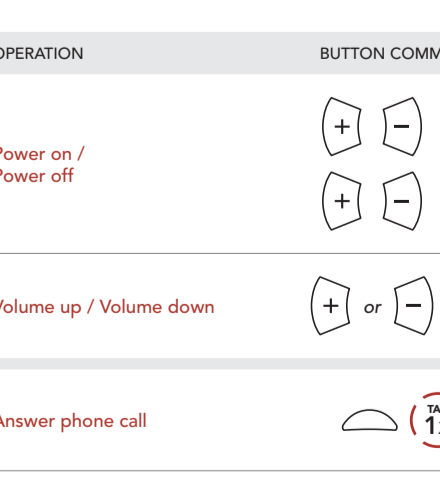

#### Intercom Pairing

There are two ways to pair the headset.

#### Using the Smart Intercom Pairing (SIP)

SIP allows you to quickly pair with your friends for intercom communication by scanning the QR code on the **SENA MOTORCYCLES App** without remembering the button operation.

- Pair the mobile phone with the headset.
- Open the **SENA MOTORCYCLES App** and tap (Smart Intercom Pairing Menu).
- Scan the **QR code** displayed on your friend (B)'s mobile phone.
  - Your friend (B) can display the QR code on the mobile phone by tapping > **QR code** on the **SENA MOTORCYCLES App**.



Note: The **Smart Intercom Pairing (SIP)** is not compatible with Sena products that use **Bluetooth 3.0 or below**.

#### Using the Button



- Users (You, B) enter into **Intercom Pairing**.



- Tap the **Multi-function Button** on either headset. Confirms intercoms are paired.



- Repeat the steps above to pair with **other headsets (C and D)**.

### Last-Come, First-Served

If the headset has multiple paired headsets for intercom conversations, the last paired headset is set as the **First Intercom Friend**.

#### Intercom Pairing Order

#### Last-Come, First-Served



### Two-way Intercom

#### Start/End Conversation with the First Intercom Friend D



#### Start/End Conversation with the Second Intercom Friend C



#### Start/End Conversation with the Third Intercom Friend B



#### Intercom Conversation with Intercom Friend



### Configuration Menu

#### Accessing the Configuration Menu



#### Navigating Between Menu Options



#### Execute Menu Options



### Troubleshooting

#### Fault Reset



Note: **Fault Reset** will not restore the headset to factory default settings.

#### Factory Reset



### Quick Reference

TYPE	OPERATION	BUTTON COMMANDS
Basic Operations	Power on / Power off	or
	Volume up / Volume down	
	Answer phone call	
Mobile Phone	End phone call	
	Reject phone call	
	Voice dial	
Intercom	Intercom pairing	or
	Start/End intercom	
	Play/Pause music	
Music	Track forward	
	Track backward	